

SINGLE WIDTH

DOUBLE WIDTH

PART NUMBER MTD. VERTICAL RACK	PART NUMBER (SEE NOTE 1)	PANEL WIDTH	A	B
201-010-010	201-010-020	19" [482.6]	24.06 [611.2]	20.56 [522.3]
201-040-010	201-040-020	24" [609.6]	29.06 [738.2]	25.56 [649.3]

PART NUMBER MTD. VERTICAL RACK	PART NUMBER (SEE NOTE 1)	PANEL WIDTH	A	B
202-010-010	202-010-020	19" [482.6]	48.12 [1222.4]	44.62 [1133.5]
202-040-010	202-040-020	24" [609.6]	58.12 [1476.4]	54.62 [1387.5]

TRIPLE WIDTH

PART NUMBER MTD. VERTICAL RACK	PART NUMBER (SEE NOTE 1)	PANEL WIDTH	A	B
203-010-010	203-010-020	19" [482.6]	72.19 [1833.6]	68.69 [1744.7]
203-040-010	203-040-020	24" [609.6]	87.19 [2214.6]	83.69 [2125.7]

NOTES:

- 1) PART NUMBERS ARE USED FOR SLOPE FRONT CONSOLES, SLOPE FRONT, VERTICAL RACKS, AND DESK, BENCH, COUNTER HEIGHT RACKS.
- 2) SEE PAGE 61 FOR FURTHER DETAILS ON WORK/Writing SHELF.
- 3) LAMINATED PLASTIC OR STEEL INSERT PANEL MUST BE ORDERED SEPERATELY.

VIEWS SHOWING SHELF

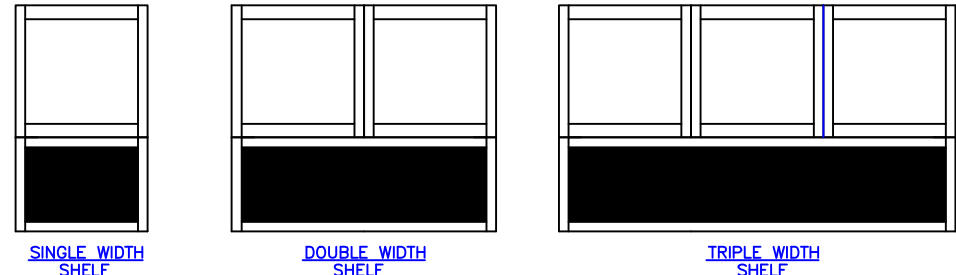

TOP VIEW

VIEWS SHOWING HEIGHTS

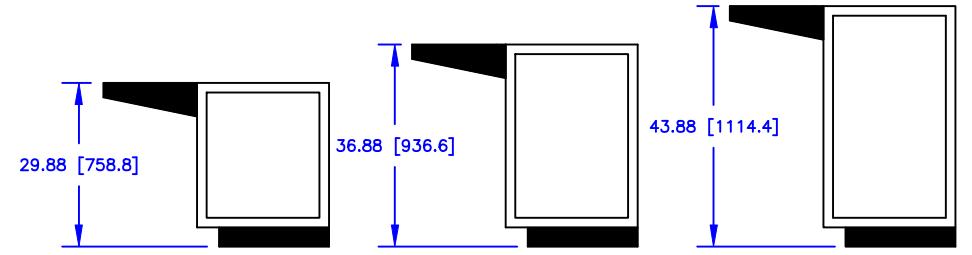

DIMENSIONS SHOWN INCHES [MILLIMETER] TOLERANCES EXCEPT AS SHOWN .XXX ±.015 [.40] .XX ±.030 [.79]

DESK HEIGHT

BENCH HEIGHT

COUNTER HEIGHT

INVERTIBLE WORK/Writing SHELF, 17" [431.8] WORK SPACE, AVAILABLE IN SINGLE, DOUBLE, & TRIPLE WIDTHS

THE INVENTION, DESIGN, DETAIL AND TECHNICAL DATA SHOWN IN THIS REPRODUCTION OF ONE OF OUR PROPRIETARY ENGINEERING DRAWINGS IS THE PROPERTY OF EQUIPTO ELECTRONICS CORPORATION AND MUST BE USED SOLELY IN CONSIDERING THE PURCHASE FROM EQUIPTO ELECTRONICS CORPORATION OF THE EQUIPMENT OR MATERIAL DESCRIBED. ALL RIGHTS IN RESPECT THERETO ARE, THRU THIS DECLARATION, EXPRESSLY RESERVED, SPECIFICALLY PRECLUDING THE COPYING IN WHOLE OR PART WITHOUT OUR WRITTEN CONSENT.

EQUIPTO ENCLOSURE SYSTEMS