

1/2-13 WELD NUTS APPLIED ONLY WHEN
LEVELING GLIDES ARE SPECIFIED -13

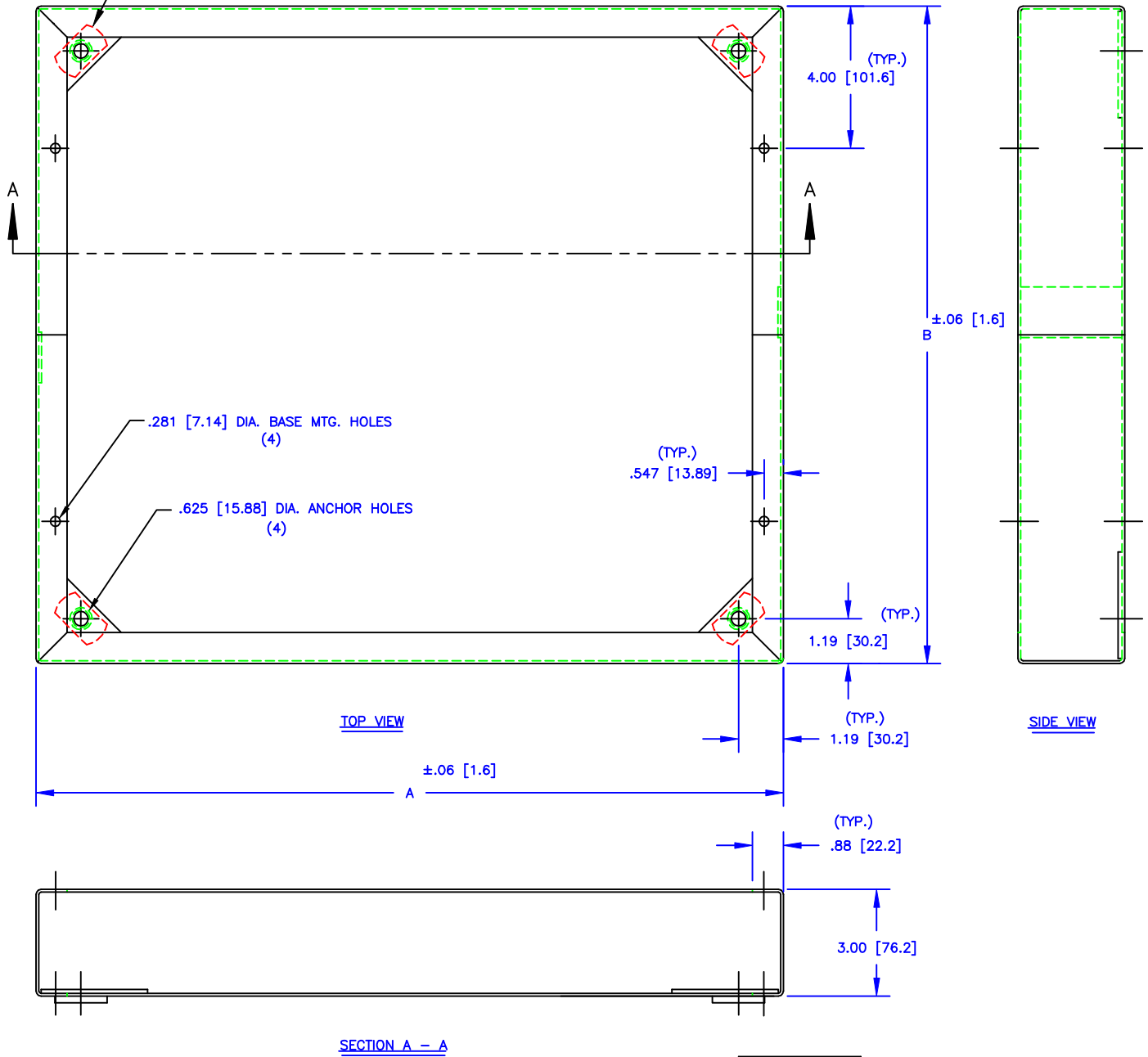

DIMENSIONS SHOWN
INCHES [MILLIMETER]

TOLERANCES EXCEPT
AS SHOWN .XXX ±.015 [.40]
.XX ±.030 [.79]

PANEL WIDTH	BASE ASSEMBLY	
	PART NUMBER	
19" [482.6]	04-1918-11	21.03 [534.2] 18.50 [469.9]
	04-1922-11	21.03 [534.2] 22.00 [558.8]
	04-1925-11	21.03 [534.2] 25.50 [647.7]
	04-1930-11	21.03 [534.2] 30.75 [781.1]
24" [609.6]	04-2418-11	26.03 [661.2] 18.50 [469.9]
	04-2422-11	26.03 [661.2] 22.00 [558.8]
	04-2425-11	26.03 [661.2] 25.50 [647.7]
	04-2430-11	26.03 [661.2] 30.75 [781.1]

THE INVENTION, DESIGN, DETAIL AND TECHNICAL DATA SHOWN IN THIS REPRODUCTION OF ONE OF OUR PROPRIETARY ENGINEERING DRAWINGS IS THE PROPERTY OF EQUIPTO ELECTRONICS CORPORATION AND MUST BE USED SOLELY IN CONSIDERING THE PURCHASE FROM EQUIPTO ELECTRONICS CORPORATION OF THE EQUIPMENT OR MATERIAL DESCRIBED. ALL RIGHTS IN RESPECT THERETO ARE, THRU THIS DECLARATION, EXPRESSLY RESERVED, SPECIFICALLY PRECLUDING THE COPYING IN WHOLE OR PART WITHOUT OUR WRITTEN CONSENT.

EQUIPTO ENCLOSURE SYSTEMS

FLUSH BASES